



Spare parts catalogue

**Winch**  
**S19**

**DINAMIC OIL S.p.A.**

Via Togliatti, 15  
41030 Bomporto (MO)  
tel +39.059.812611  
fax +39.059.812603  
dinamicoil@dinamicoil.it

Spare parts catalogue No.

**L577**

Logbook code

**WS0019S0JA20**

Edition

**23/04/2014**

Revision

**0**



<b>Table index</b>	<i>Winch</i>	<b>S19</b>
	<i>Logbook code</i>	<b>WS0019S0JA20</b>

<b>Page</b>	<b>Table code</b>	<b>Table heading</b>
3	<b>WS0019S0JA00-1</b>	WINCH S 19 CCW SMOOTH Ø12
4	<b>WS0019S0JA00-2</b>	WINCH S 19 CCW SMOOTH Ø12
5	<b>02981041</b>	BRAKE GROUP S15/S19 OMSU
6	<b>905156100-1</b>	UNIFIED CABLE PRESS S15-S19 KIT
7	<b>905156100-2</b>	UNIFIED CABLE PRESS S15-S19 KIT

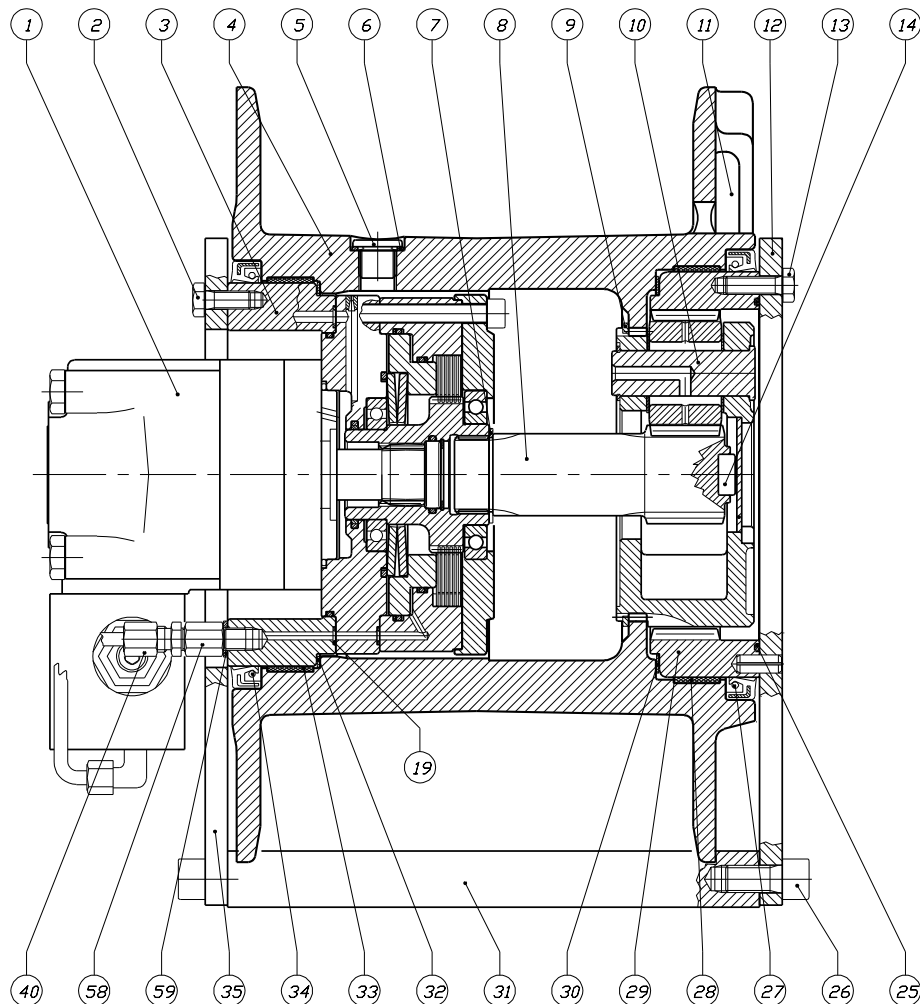

Pos	Code	Qty	Description
1	425026600	1	MOTOR OMSU 200 3S.151F0582
2	410208900	6	HEX HEAD CAP SCREW M8X20 8.8 UNI 5739
3	02981041	1	BRAKE GROUP S15/S19 OMSU
4	02301011	1	DRUM S15-S19
5	419000700	2	PLUG TCEI 3/8" GAS DIN908
6	423000600	2	SOFT COPPER WASHER 3/8" UNI 6953
7	421000500	1	SHAFT SEEGER Ø35
8	02611016	1	SUN GEAR RE 250 R=1:5,8 S15-S19
9	415022100	1	SHOULDER RING WR130 FOR SHAFT
10	4050001000	1	GEAR SUBASSEMBLY P15/S15 RE 250 1:5,7
11	02410208	1	THIMBLE S19-P15/E Ø12 S19N Ø11
12	02340212	1	GEAR SIDE SUPPORT S15-S19
13	410201100	16	HEAGOLAN SCREW M8X25 10.9 UNI 5739
14	01021000	1	WHEEL GEARBOX PAD EH 200 PD
19	406001400	1	O-RING 2-010
25	406016800	1	O-RING 2-163 N 674-70 (PARKER)
26	410407700	8	HEX SOCKET HEAD CAP SCREW M12X25 12.9
27	415012800	1	SEAL RING 180X200X13 BASL
28	405022900	1	GUIDE RING ATS-F 180X185X19.5 RFG
29	02231008	1	TOOTHED RING GEAR S15-S19
30	427016400	1	THICKNESS SHIM ADJUSTMENT 160X176X1
31	02451003	2	FIXING PLATE S15
32	294131100	1	SHIM RING P6 160X170X1
33	405022800	1	GUIDE FIXING ATS-F 170X175X19.5 RFG
34	415090400	1	OIL SEAL 170X190X13 BASL
35	02340211	1	MOTOR SIDE SUPPORT S15-S19
40	440001000	1	STRAIGHT CONNECTOR 1/8"G TAPERED (Ø6)
58	442025600	1	SHORT STUD MF 1/8 L=17
59	423203900	1	RUBBER WASHER 1/8"GAS

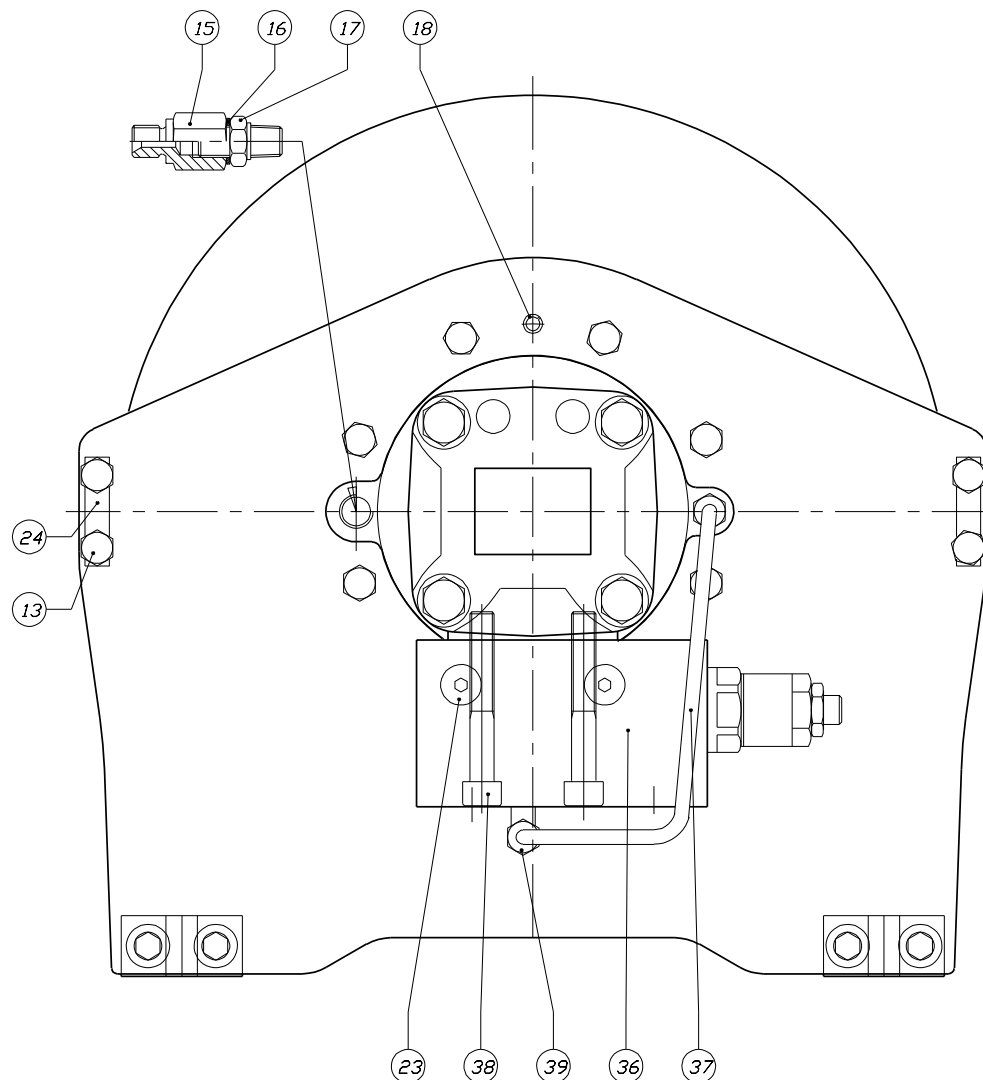

Pos	Code	Qty	Description
13	410201100	16	HEAGOLAN SCREW M8X25 10.9 UNI 5739
15	442024500	1	SHORT STUD MF 1/4"G L=32
16	423000300	1	SOFT COPPER WASHER 1/4" UNI6953
17	442024800	1	JOINT 1/4 MM GAS CONICAL-CILIND..
18	434010500	4	ELASTIC PIN Ø8X20 UNI6873 HEAVY TYPE (ISO 8752)
23	410040400	2	HEX SOCKET COUNTERSUNK HEAD CAP SCREW M8X20 10.9
24	02451002	2	CROSS MEMBER S15
36	438022100	1	VALVE VOC120 FMDSS CH/8 15AY 06B
37	02671032	1	BRAKE PIPE S19 SX
38	410406100	2	HEX SOCKET HEAD CAP SCREW M10X70 12.9
39	440000100	1	CONNECTOR 90° 1/8"G CONICAL PIPE D6

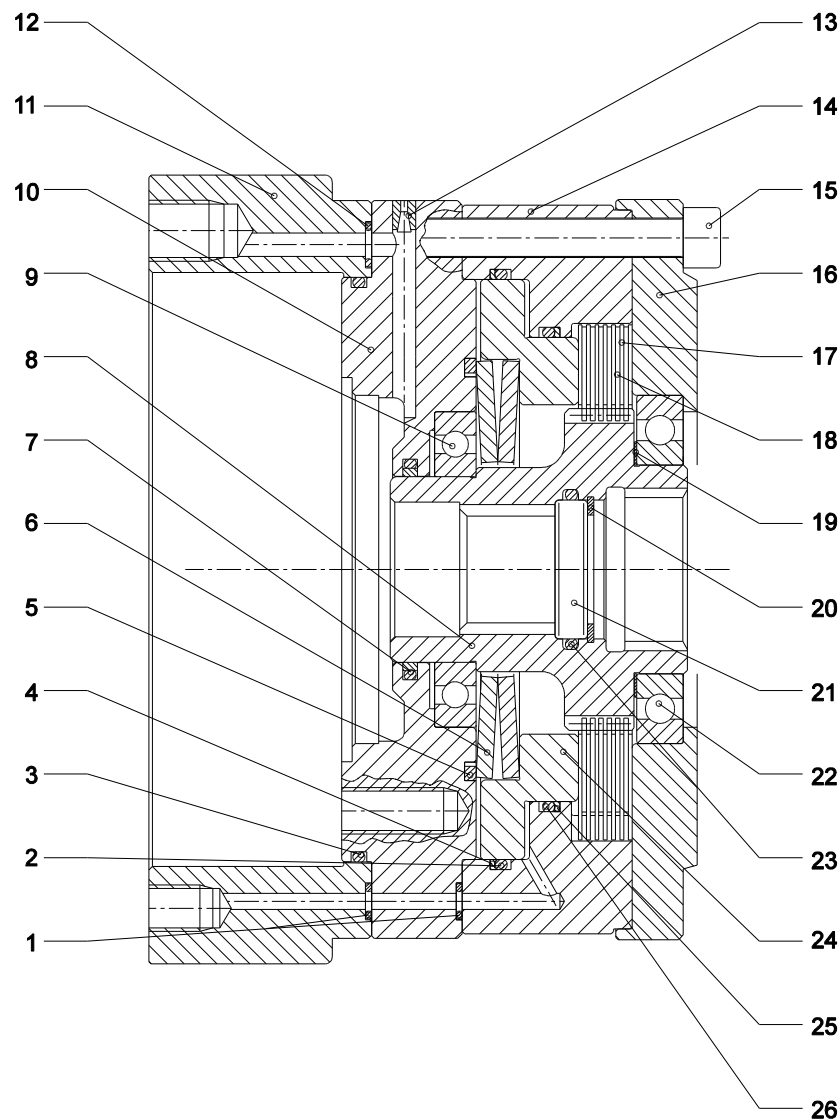

Pos	Code	Qty	Description
1	406001100	2	O-RING 2-008
2	406016700	1	O-RING N 674-70 (PARKER)
3	406012500	1	O-RING 2-158
4	415067500	1	ANTIEXTRUSION PARBAK 8-159
5	415021200	1	SHOULDER RING BR 90 FOR HOLE
6	416201400	2	CUP SPRING 90X46X3,5 DIN 2093
7	415061900	1	SEAL ROTO-GLYD RING S 56131-0400-A42-N
8	02241087	1	HOLDER DISC GEAR S15 OMSU
9	400003900	1	BALL BEARING 16008
10	02461063	1	MOTOR FIXING FLANGE S15-S19
11	02751022	1	DRUM SUPPORT RING S15-S19 OMSU
12	406001400	1	O-RING 2-010
13	414001300	1	PLUG SK 550-050
14	02431013	1	BRAKE BODY S15
15	410404000	8	HEX SOCKET HEAD CAP SCREW M8X80 12.9
16	02461011	1	BRAKE CLOSING FLANGE S15
17	02941016	7	LAMINAR STEEL PLATE TH.0,8 S15
18	02941017	6	STEEL BLADE SP.1 INTERNAL TOOTHED
19	427004900	1	THICKNESS SHIM ADJUSTMENT 45X55X0,5
20	421100400	1	HOLE SEEGER Ø30
21	02741005	1	SHIMMING PAD S15 Ø30X7
22	406005800	1	O-RING 2-123 PARKER (N674-70)
23	400003000	1	BALL BEARING 16009 KIND B
24	02271007	1	BRAKE PISTON S15
25	406015900	1	O-RING 2-155 N 741-75 (PARKER)
26	415069000	1	ANTIEXTRUSION FLUORTEN T-2684 (8-155)

Pos	Code	Qty	Description
1	02490275	2	CABLE PRESS COUPLING PLATE INOX S15/S19
2	029917176	1	CABLEPRESS ARM 07 INOX
3	029813102	2	NYLON CLAMP GROUP Ø20
4	02490285	4	SPRING PLATE I=8
5	418205200	4	TRACTION SPRING DIM T42500 INOX

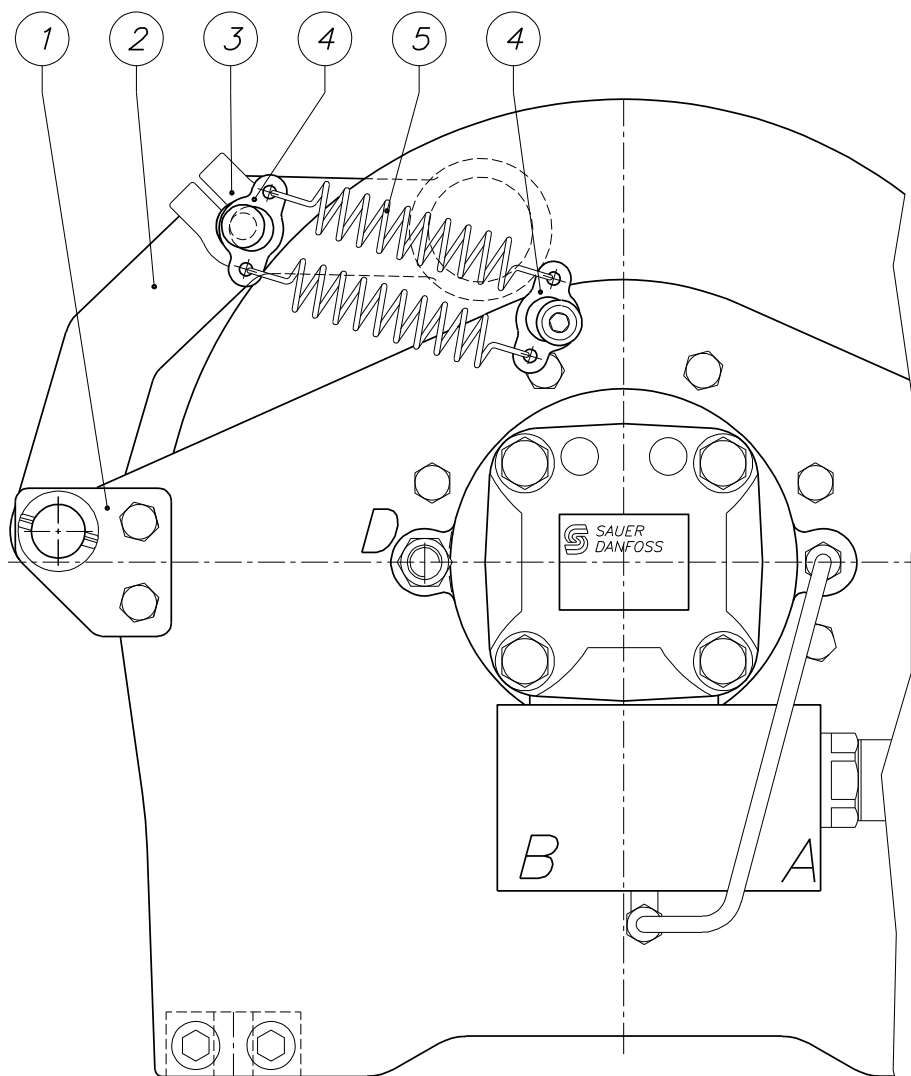

Pos	Code	Qty	Description
6	02601630	1	INOX CABLE PRESS PIN S15-19
7	421005700	2	CLIP RING DIA 20 MM INOX
8	423010500	8	NYLON WASHER Ø20.2X31.5X1
9	400026700	4	BALL BEARING 61804 2RS
10	010105100	2	CABLE PRESS ROLLER Ø53X88 ERTALON 6 PLA
11	02601629	1	ROLLER PIN Ø20X176
12	434010900	3	ELASTIC PIN Ø 5X30 UNI6873 INOX
13	02601628	1	SPRING PIN Ø20X298
14	410081200	2	HEX SOCKET HEAD CAP SCREW M8X25 INOX A2-70
15	423109700	2	FLAT WASHER Ø8.4X17X1.6 INOX
16	413002900	2	NUT M8 UNI 5588 INOX A2-70
17	423203800	2	WASHER Ø21 UNI6592 INOX SHIM 3
18	410019400	4	SCREW TE M8X30 INOX A2-70

