



Mobile series

Oil Cooling Evolution for Industrial Vehicles



← *Basic solution.*

Full Options Solution. →



EMMEGI s.p.a. is pleased to introduce an innovative product, mostly focused on the mobile applications field. With Mobile series, **EMMEGI s.p.a.** can offer different kind of solution type, suitable for each different needs.

➤ **Basic Solution.**

With the basic solution, we propose a range of simple products, composed by the cooler element (01) only and its IP67 kit DC fan (02), the fixed thermostat is an option available on request.

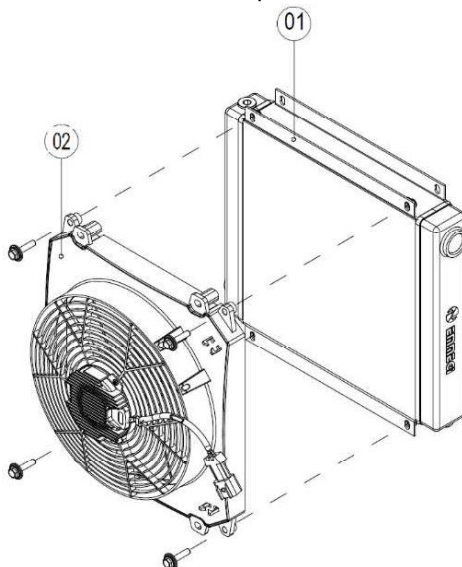

A **by-pass valve** () is always recommended in order to prevent a burst of the cooler element because of an overpressure, so **EMMEGI s.p.a.** can give you the opportunity to have it as integrated part of our cooler element on request.

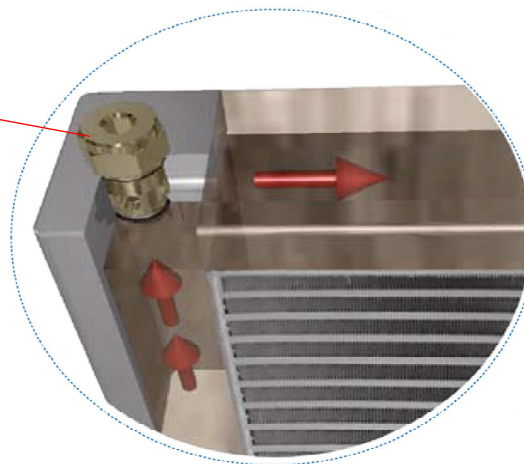
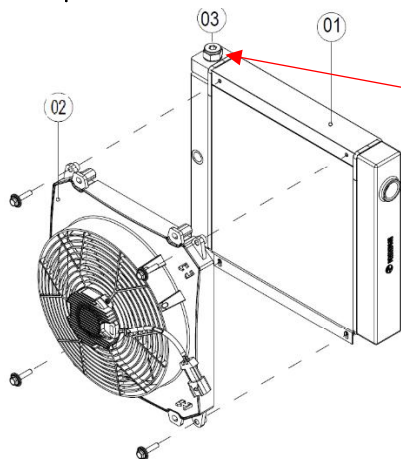

➤ **Option.**

Thanks to its 2 side-wings, the cooler can be installed on board of the vehicle with **proper dumper rubbers!**



or with its supporting frame available on demand.

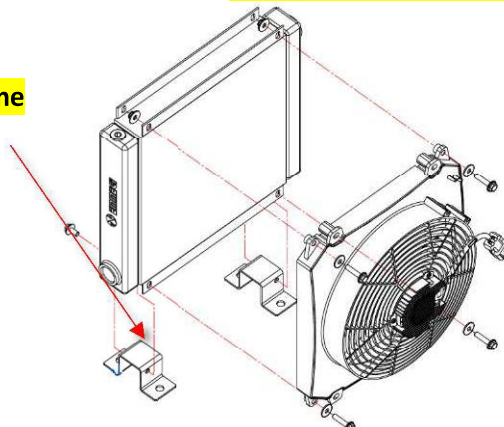

Turning the fan on and off can be controlled by a simply fixed thermostat with contact Normal Open (**IP65**).



- This accessory is available on demand with different setting of the temperature, where the most popular is 60:48°C.

➤ **Full Options Solution.**

EMMEGI s.p.a. can give you more in terms of many solutions in one product: the Mobile **PNP** (Plug & Play).

“**PLUG & PLAY**” and “**SUSTAINABILITY**” are the key concepts of this new product type.
The end user has in his hands a product ready to work; it needs to be connected only.

The 95% of the entire Mobile cooler is already composed by rust proof components and make this cooling solution a long lasting product with an excellent sustainability.

Thankful to **Soft Start** electronic device, the application power and energy consumption are highly reduced.
The **Soft Start** equipment allows to optimize the noise level with low speed fan as well.

The Mobile **PNP** it is essentially composed by parts as cooler element (**01**), **IP67** DC fan (**02**), and Electronic device (**03**), supporting feet (**04**) and temperature sensor (**05**).

